

Electrodynamic Testing System

Series LFV – E 1 kN

State-of-the-art ServoElectric testing system to execute both static and dynamic testing on materials and components including biomaterials and biomedical / dental implants, plastics, textiles composites and automotive or electronic components.

The Series LFV-E are fluid-free non-hydraulic systems currently available with force capacities up to 3 kN for fatigue and durability testing, tensile, compression, bend, peel or shear strength testing as well as crack initiation. This table top systems with its ServoElectric drive mounted on upper crosshead represents a versatile and reliable fatigue rated testing machines combined with latest drive technology. This machines are selected from testing professionals in quality control, R&D or Uni-

versities who desire a compact space saving, clean and quite low force testing unit that requires no environmental consideration and virtually no maintenance .

The ServoElectric drive with its in-line digital displacement transducer provides noise-free stroke measurement or control. This drive features backlash-free motion with no fluid compressibility to compromise position accuracy. The system is available with integral T-slot platen providing high degree of flexibility or

attachable (to the upper crosshead) closed frame often used from those who test e.g. dental implants in combination with saline bath.

The upper crosshead can be lift or lowered through integrated electrical spindles to adjust the desired test space. Only unclamp the crosshead by twisting the lever clamps and pushing the up / down bottom without any tools. The spindles for lift/lower are protected against dust or mechanical damage. An emergency stop is available direct at the testing machine as well as on the remote control unit which can be used for precise of the actuator through digital hand-wheel.

Features

- Flexible system for simple static to high frequency fatigue tests
- Clean and quite non-hydraulic drive with integral bearings
- Backlash-free motion with no fluid compressibility
- Integrated noise-free stroke transducer
- Virtually maintenance free system with lower life cycle cost
- Reduced moving parts
- Easy to operate
- Space saving compact design



Specifications

Accuracy	In accordance with ISO 7500-1 and EN 10002-2, Grade 0.5.
Control	Standard: force and displacement closed loop controlled. Option: with extensometer strain closed loop controlled.
Actuator	Mounted on upper crosshead.
Piston Stroke	Standard: ±10 mm. Others upon request.
Crosshead Adjustment	Standard: ME mechanically locked and electrical adjustment. Option: M mechanically locked and manual adjustable.
Power Requirements	3 x 400 V, 50 Hz. Others upon request.

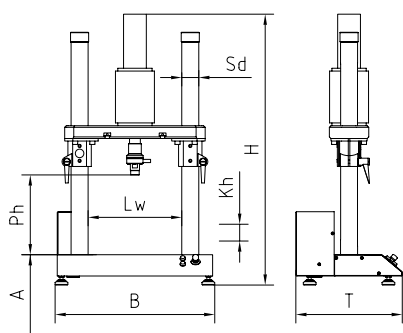

Type LFV - E		1
Max. Test Load Dynamic	kN	±1
Max. Test Load Static	kN	±1
Piston Stroke (Kh)	mm	±10
Test Chamber Height (Ph)	mm	740
Distance betw. Columns (LW)	mm	440
Column Diameter (Sd)	mm	80
Width (B)	mm	730
Depth (T)	mm	500
Height (H)	mm	1640
Weight Frame	kg	180
Frame Stiffness	kN/mm	40
Working Height with Base (A)	mm	1100
Total Dimensions with Base	mm	1400 x 700 x 2750
Total Weight Machine with Base	kg	340

